

PORTABLE AIR CONDITIONERS MONOBLOC UNIT



MUPO Series C9/H9

with outlet pipe to the outside and remote control



Ventilation function
It allows operation with only ventilation.



Remote control
Includes wireless remote control.



Air discharge tube to the outside
Easy and quick to install, it allows the use of the air conditioner immediately.



Dehumidification
Moisture reduction restoring an optimum temperature in wet areas.



Condensate removal
Removes condensate water so it is not necessary to connect the air conditioner to a drain. In dehumidification mode and in very humid environments, it is recommended to connect the equipment to a drain.



Follow Me Function (iFEEL)
The wireless remote control adds a temperature sensor (only in MUPO-12-H9 Series).

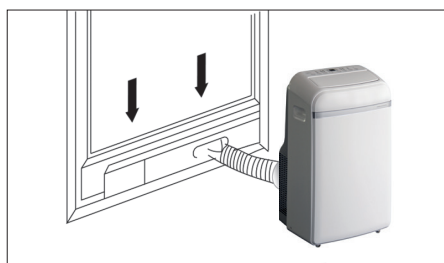

Window kit included

TECHNICAL SPECIFICATIONS

Model			MUPO-07-C9	MUPO-09-H9	MUPO-12-H9
Code			CL20013	CL20019	CL20014
Cooling	Nominal capacity	kW	2.06	2.64	3.5
	Nominal consumption P _{EER}	kW	0.792	1.01	1.35
	EER _d	W/W	2.6	2.6	2.6
	Energy labeling		A	A	A
	Electricity Consumption Q _{sd}	kWh/60min.	0.792	1.01	1.4
Heating	Nominal capacity	kW	-	2.1	2.9
	Nominal consumption P _{COP}	kW	-	0.905	1.04
	COP _d	W/W	-	2.3	2.8
	Energy labeling		-	A	A+
	Electricity Consumption Q _{sd}	kWh/60min.	-	0.905	1.1
Power consumption in thermostat-off mode Pro		W	-	-	1
Standby power consumption P _{ss}		W	1	1	0.5
Sound power level L _{wa}		dB(A)	65	65	65
Power supply		V-Hz-Ph	220-240V~ 50Hz, 1N		
Max. current		A	3.51	4.4	8
Air flow rate	Indoor	m³/h	300	350	420/370/355
	Exterior	m³/h	300	350	535
Diameter of air discharge hose		mm	150	150	150
Refrigerant	Type / PCA		R290/3		
	Amount	kg / TCO ₂ EP	0.13/0.0	0.21/0.0	0.195/0.0
Dimensions (W x D x H)		mm	305x328x678	354x338x698	467x397x765
Weight		kg	21	22	34.4

Warning: 1. Data and specifications are subject to changes without previous notice.
2. The values of noise level match with values obtained in the anechoic chamber.